

## Software Instructions

### Mode 1: Program Change A (PC Code)

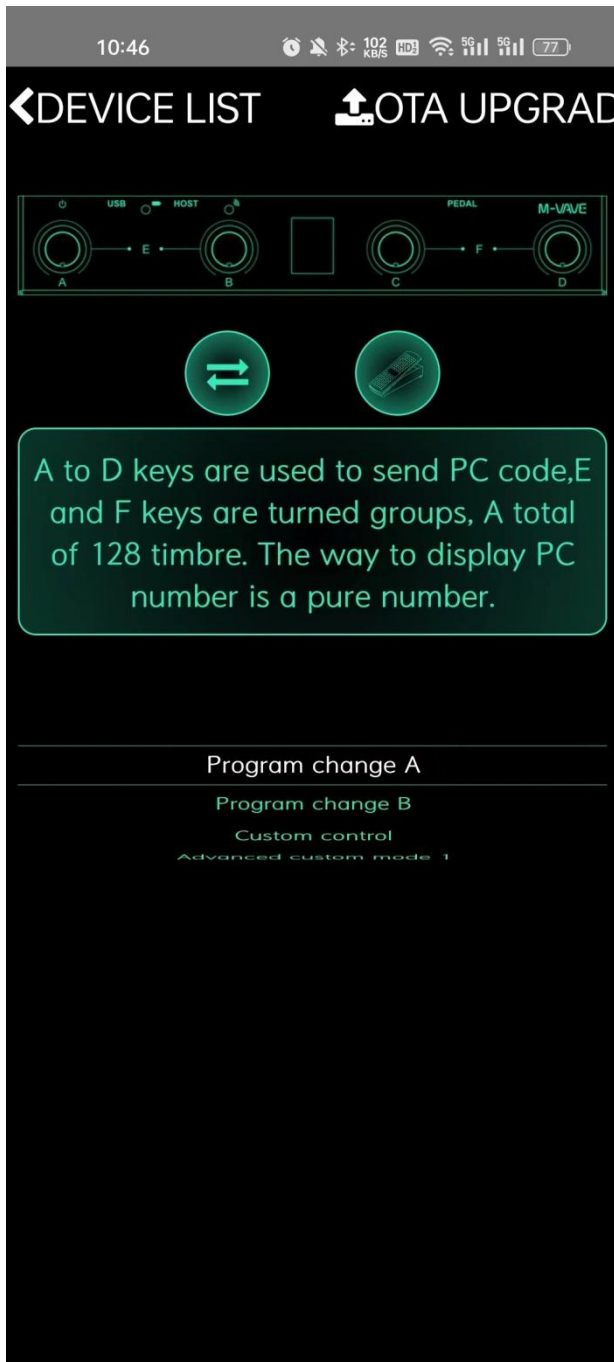

Content: PC codes from PC 0 to PC 127

Switching Groups: Use buttons E and F to switch groups

Display: The specific PC code will be shown on the display screen

## Mode 2: Program Change B (CC Code)

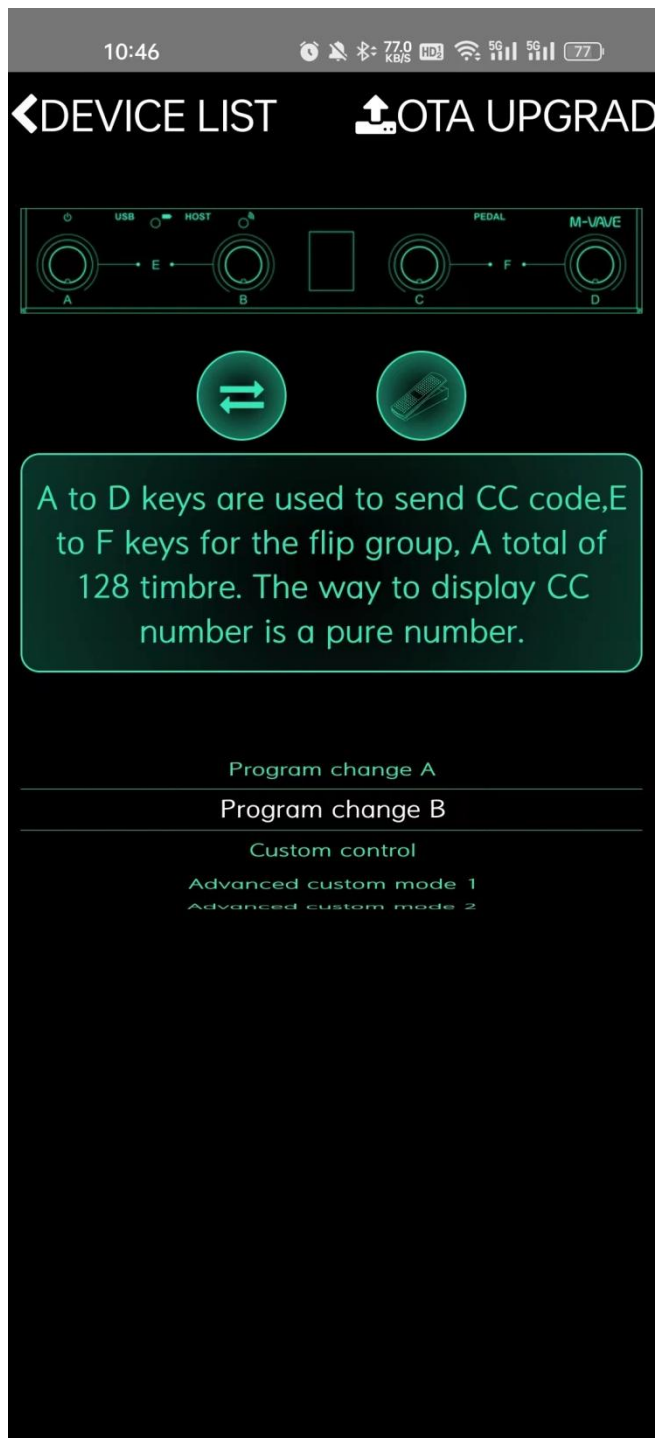

Content: CC codes from CC(0,0) to CC(127,0)

Switching Groups: Use buttons E and F to switch groups

Display: The specific CC code will be shown on the display screen

### Mode 3: Custom Mode (CC Code)

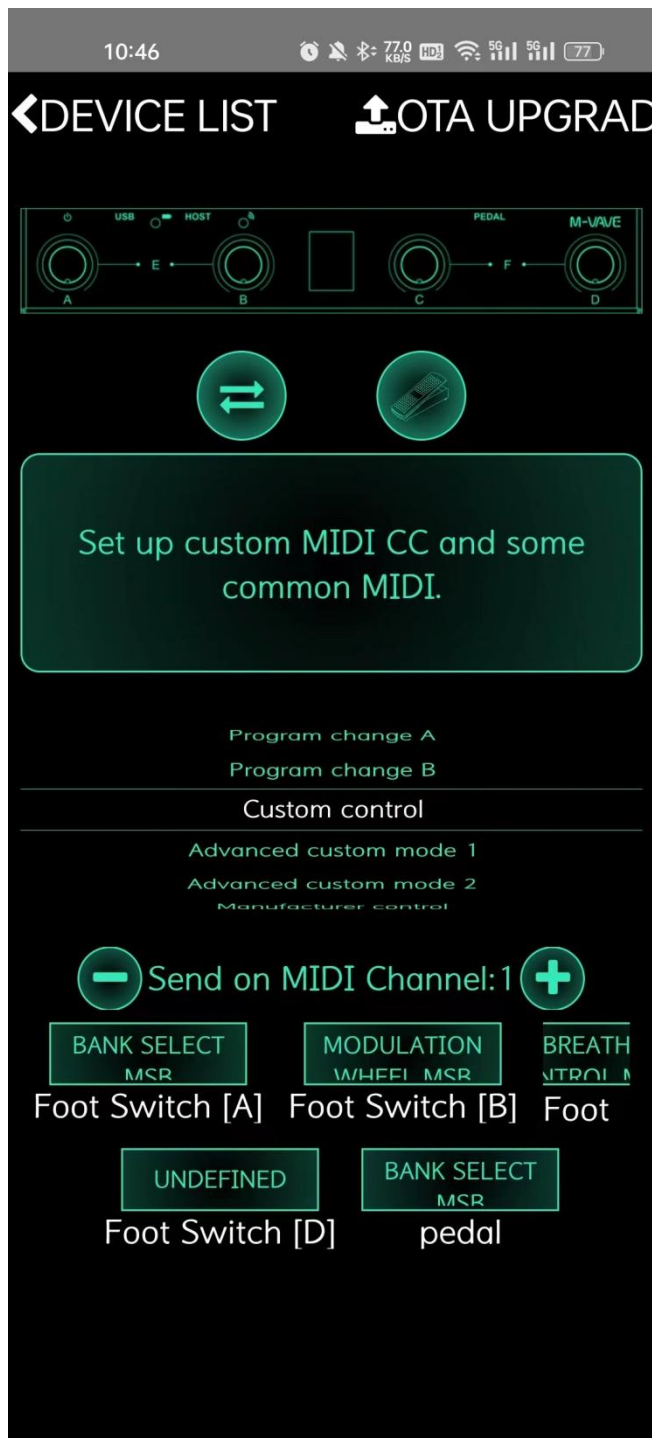

Content: CC codes

MIDI Channel: Can be selected

Footswitch: Clicking on the corresponding footswitch will send a toggle code. For example, for CC1, it can simultaneously send CC(1,1) and CC(1,0)

Mode 4: Advanced Custom Mode 1 (Various MIDI Codes)

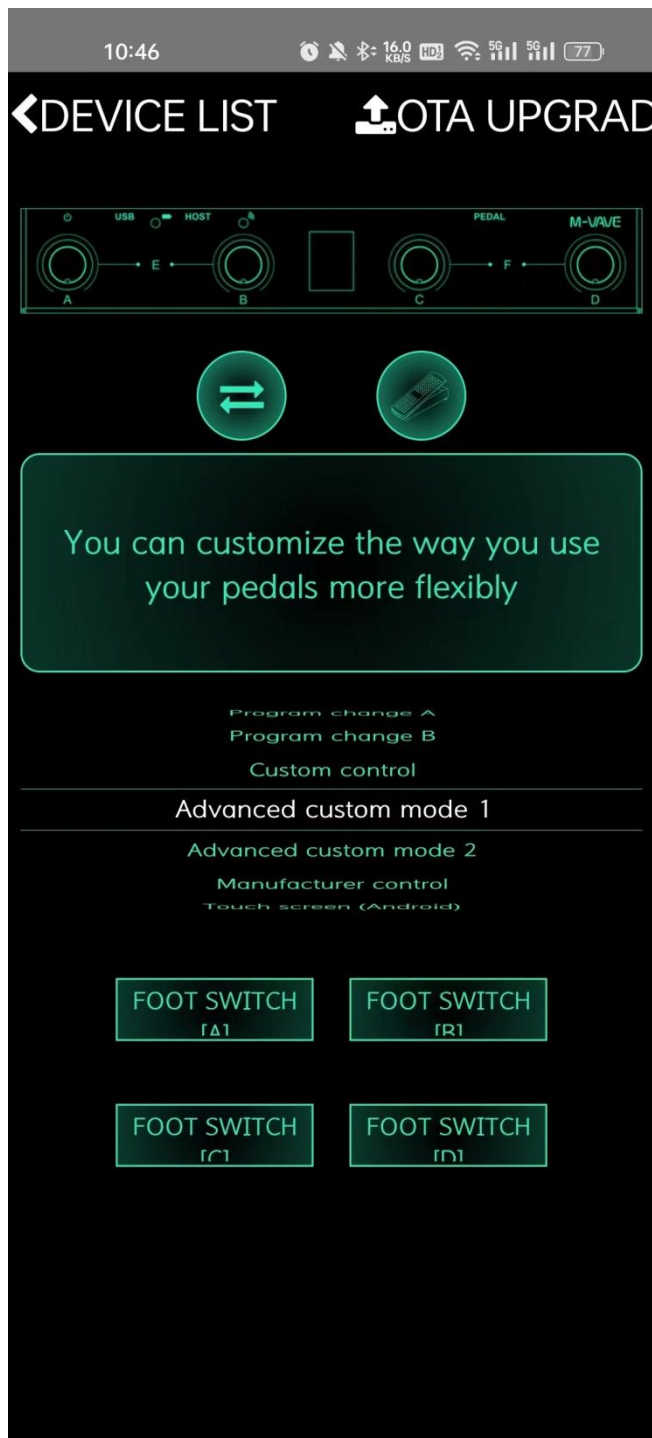

Content: Five sub-modes with various types of MIDI codes

MIDI Channel: Can be selected

Switching Groups: Cannot switch banks using buttons E and F

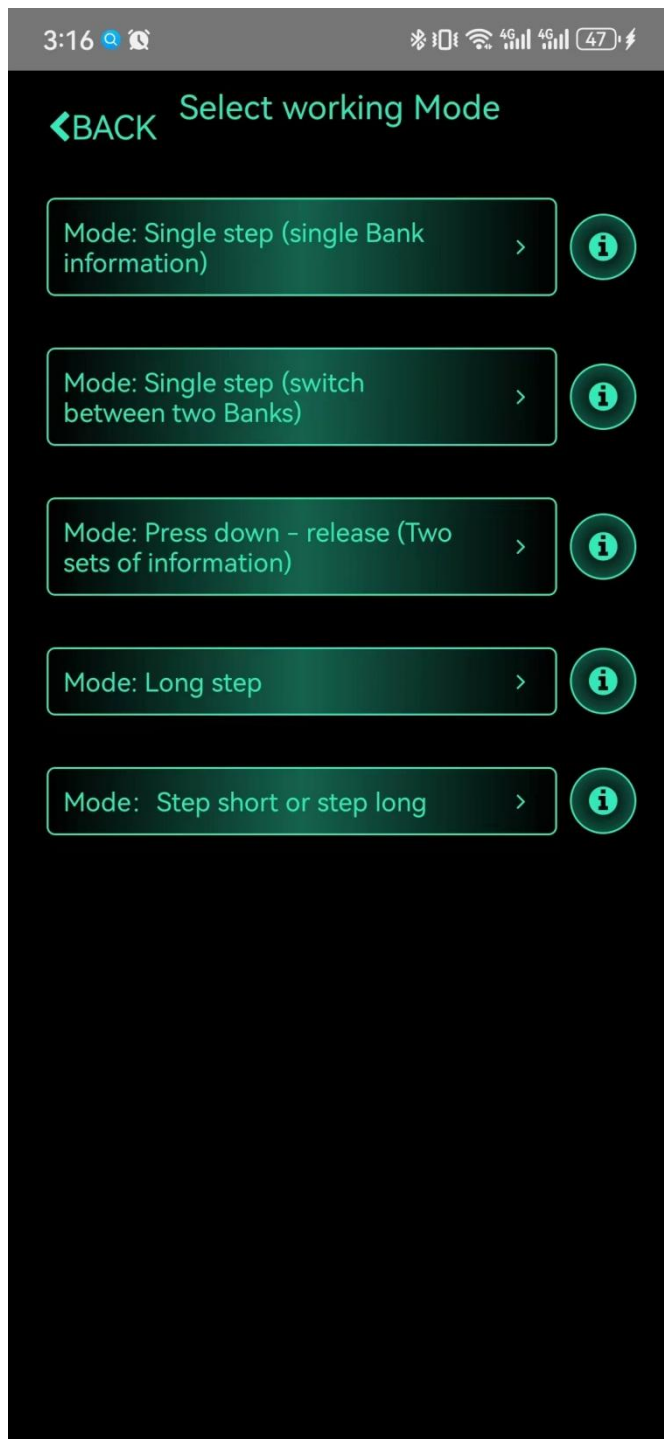

#### Five Modes:

(1) Single Tap (Single Group of Information):Sends a corresponding MIDI code with each short tap. The same MIDI code is sent each time.

(2) Single Tap (Two Groups Switching):Sends two different MIDI codes alternately with each short tap. For example, the first tap sends PC1, the second tap sends PC2, and then it repeats.

(3) Press-Release (Two Groups Switching):Sends two different MIDI codes with press and release actions. For example, pressing sends PC1, releasing sends PC2.

(4) Long Press: Sends a corresponding MIDI code with a long press. The same MIDI code is sent each time.

(5) Short Tap-Long Press: Sends two different MIDI codes with a short tap and a long press. For example, a short tap sends PC1, and a long press sends PC2. This mode can be used to send toggle codes.

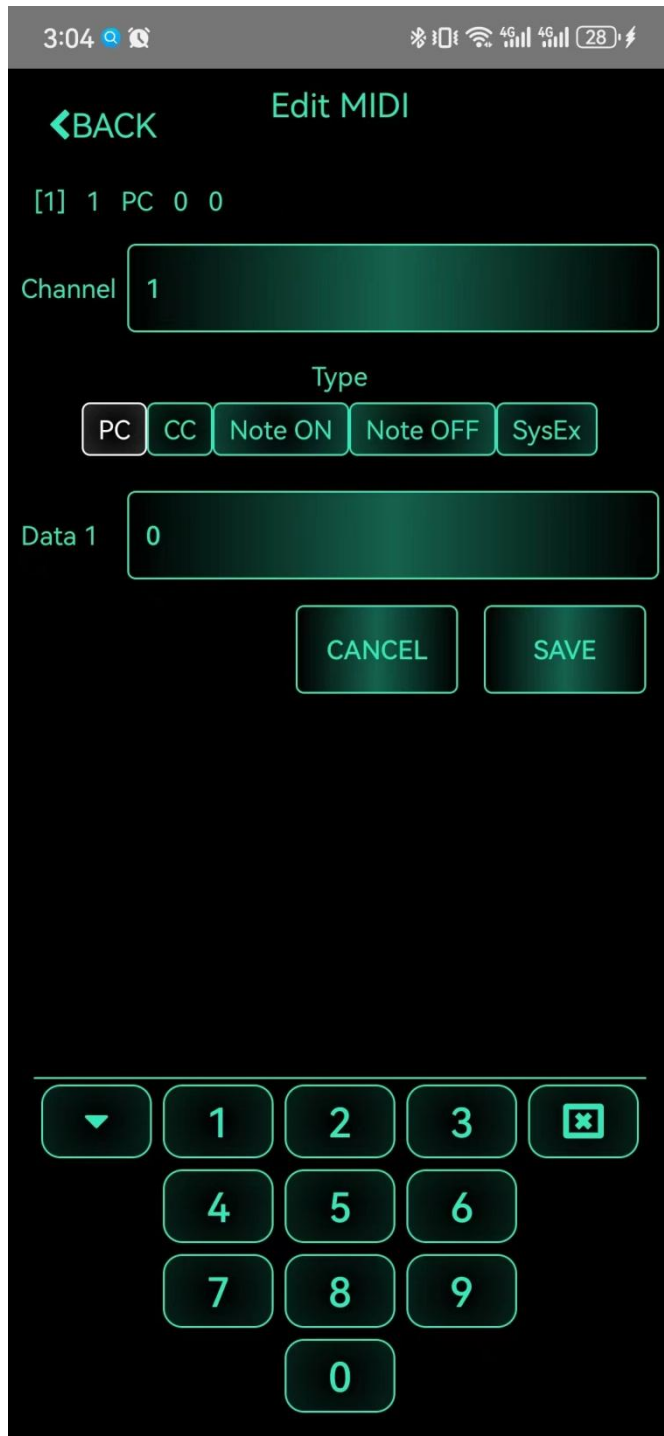

Included MIDI Codes: PC codes, CC codes, NOTE ON and NOTE OFF codes, and SYSEX codes.

Mode 5: Advanced Custom Mode 2 (Various MIDI Codes)

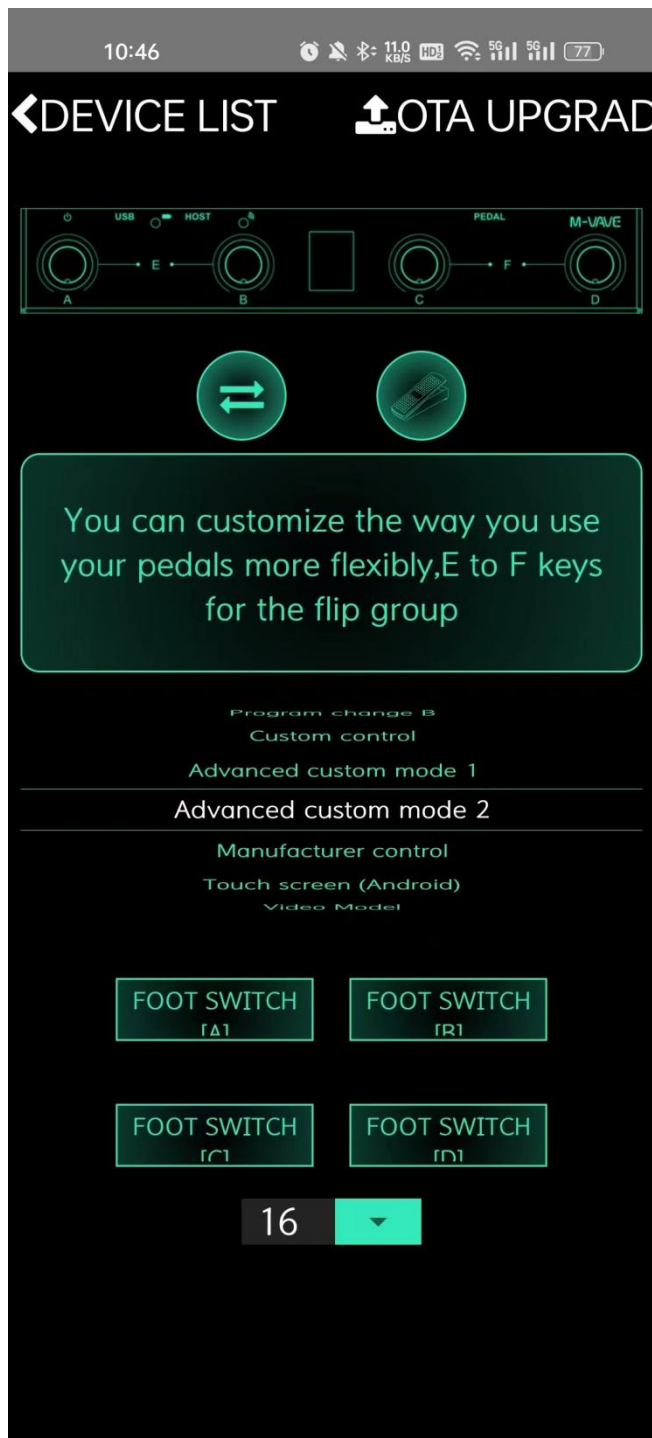

Content: Only short tap and long press modes

MIDI Channel: Can be selected.

Switching Groups: Can switch banks using buttons E and F (up to 16 groups can be selected in the software).

Included MIDI Codes: PC codes, CC codes, NOTE ON and NOTE OFF codes, and SYSEX codes.

Mode 6: Manufacturer Device Control Mode.

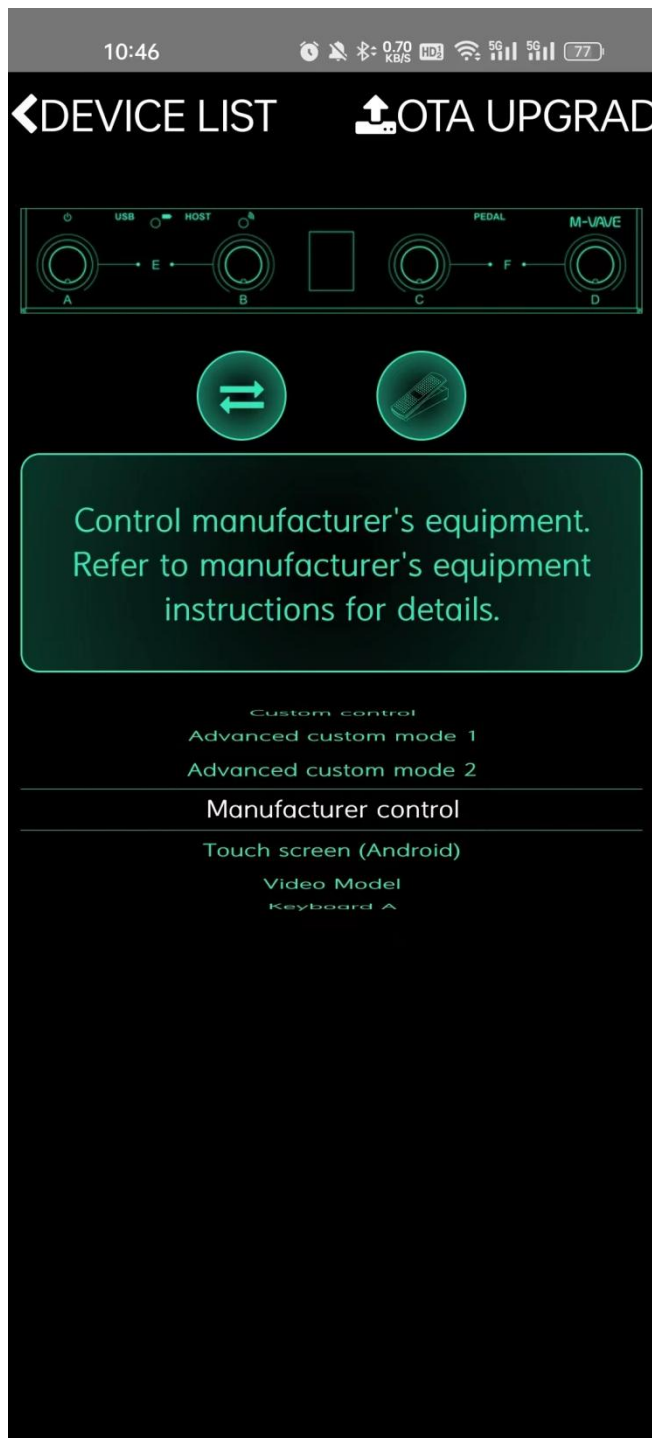

Content: Internal mode for controlling M-VAVE brand products such as TANK-G, LOOPER PRO, and LOST TEMPO.

## Mode 7: Touchscreen Mode

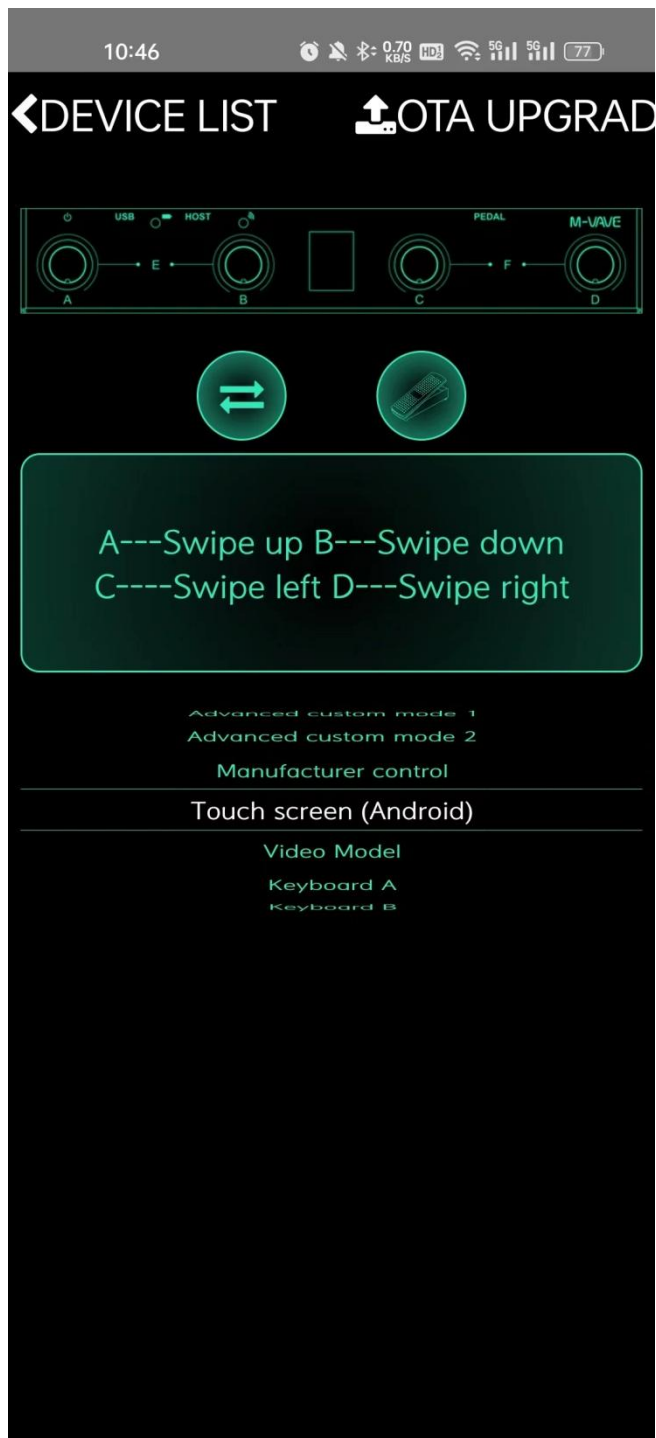

Content: The four footswitches correspond to:

- A: Swipe up
- B: Swipe down
- C: Swipe left
- D: Swipe right

## Mode 8: Video Mode

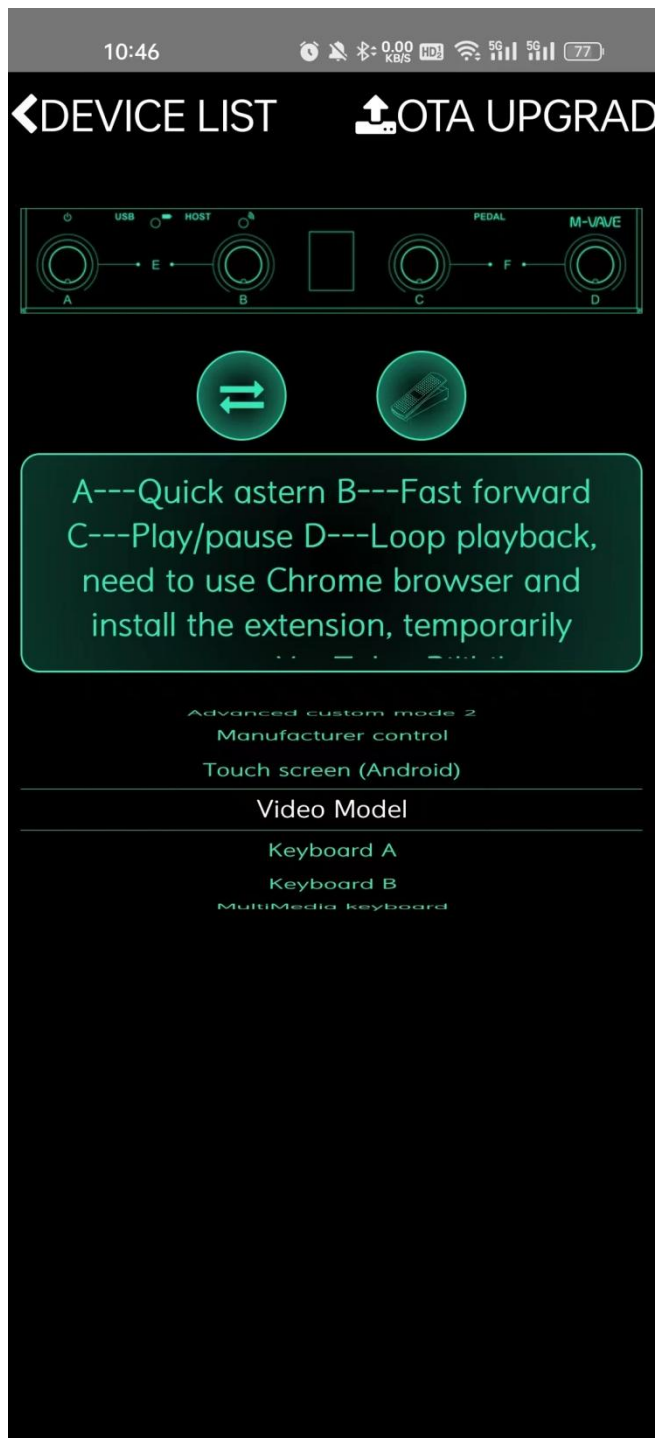

Content: The four footswitches correspond to:

A: Rewind

B: Fast forward

C: Pause/Play

D: Loop

Note: The loop function requires the Chrome browser and an extension. Currently supported websites: YouTube, Bilibili.

## Mode 9: Keyboard Mode A

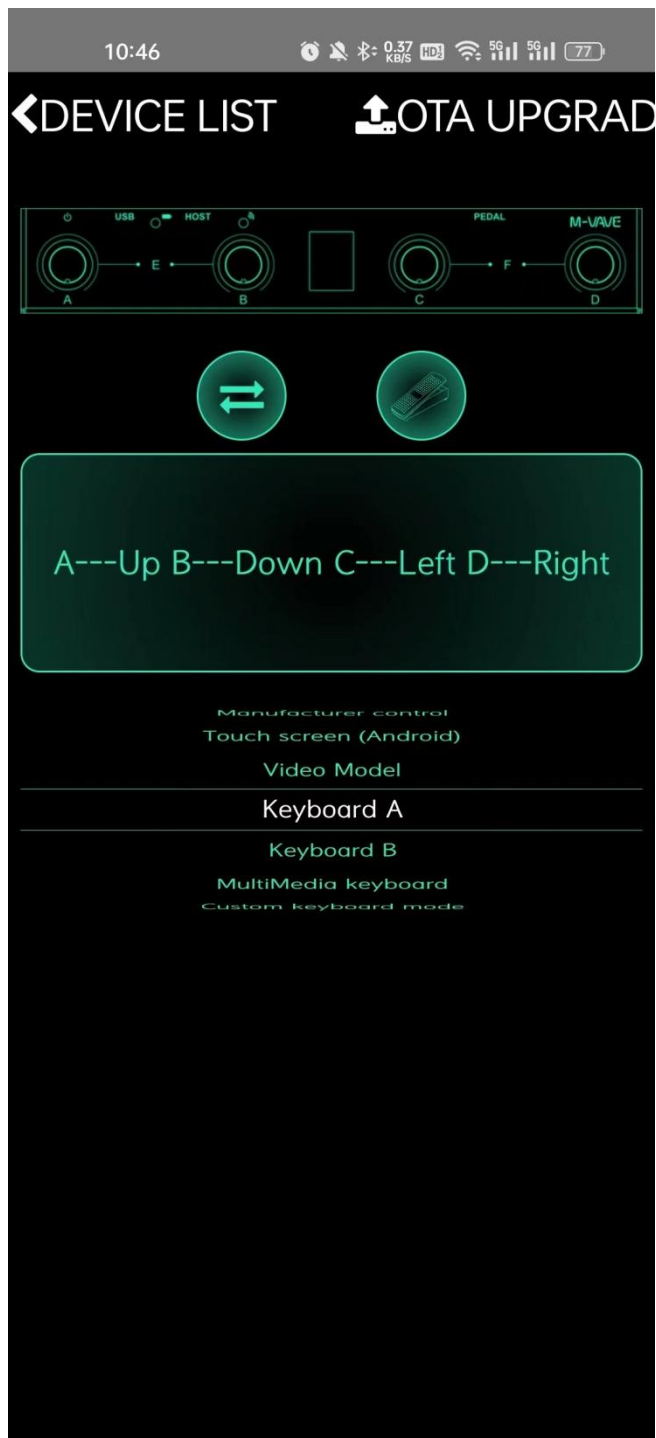

Content: The four footswitches correspond to keyboard keys:

- A: Up
- B: Down
- C: Left
- D: Right

## Mode 10: Keyboard Mode B

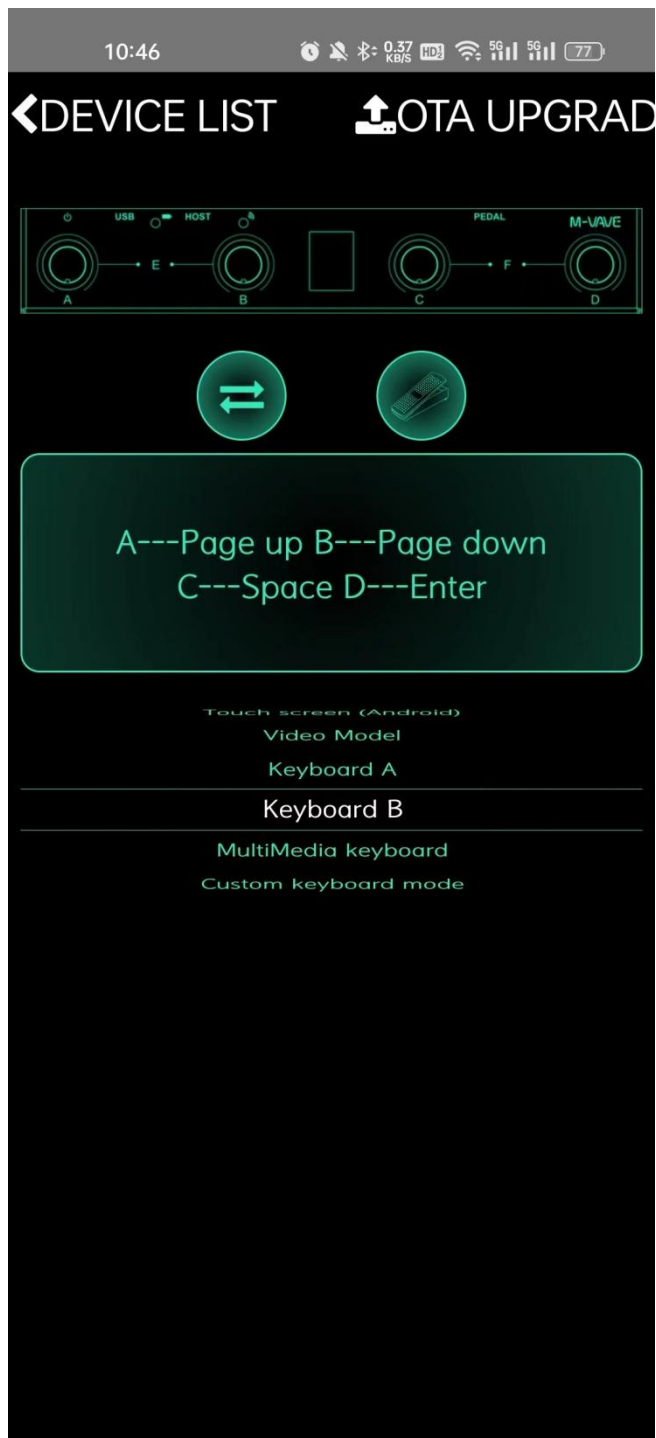

Content: The four footswitches correspond to keyboard keys:

A: Page Up

B: Page Down

C: Space

D: Enter

Mode 11: Multimedia Key Mode

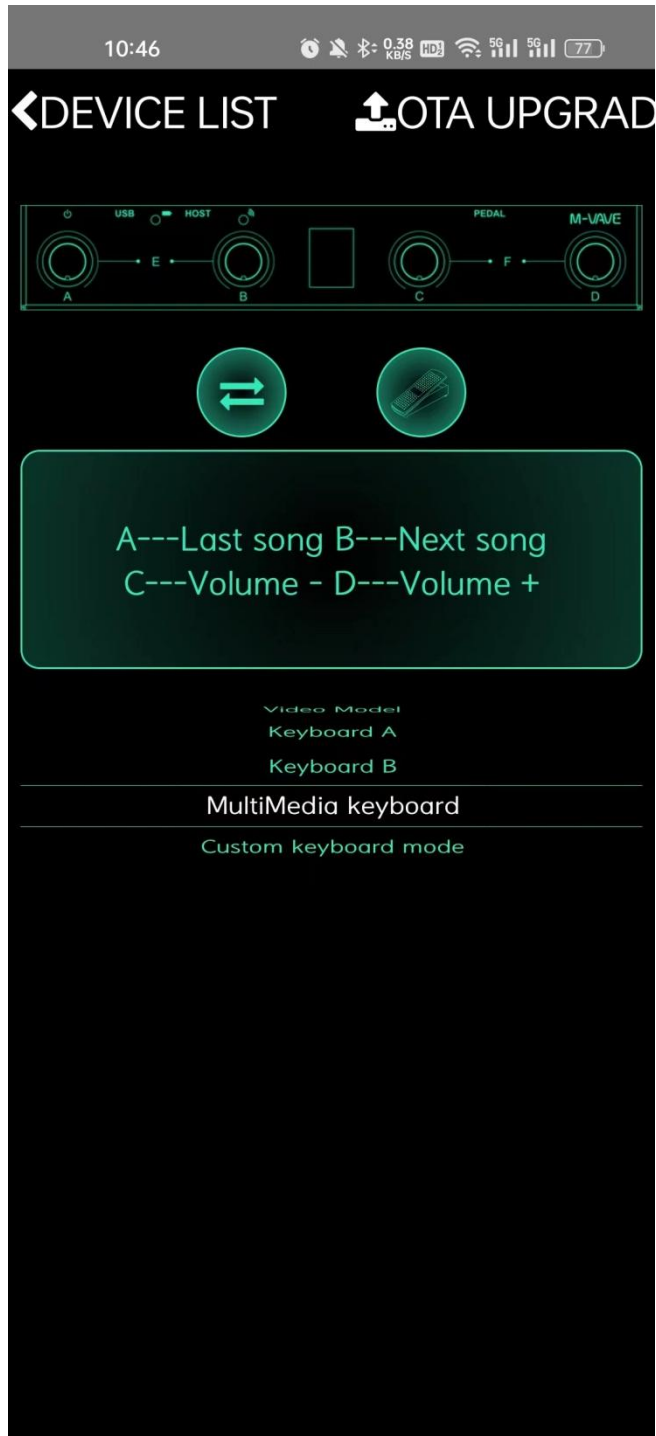

Content: The four footswitches correspond to multimedia keys:

A: Previous track

B: Next track

C: Volume down

D: Volume up

## Mode 12: Custom Keyboard Mode

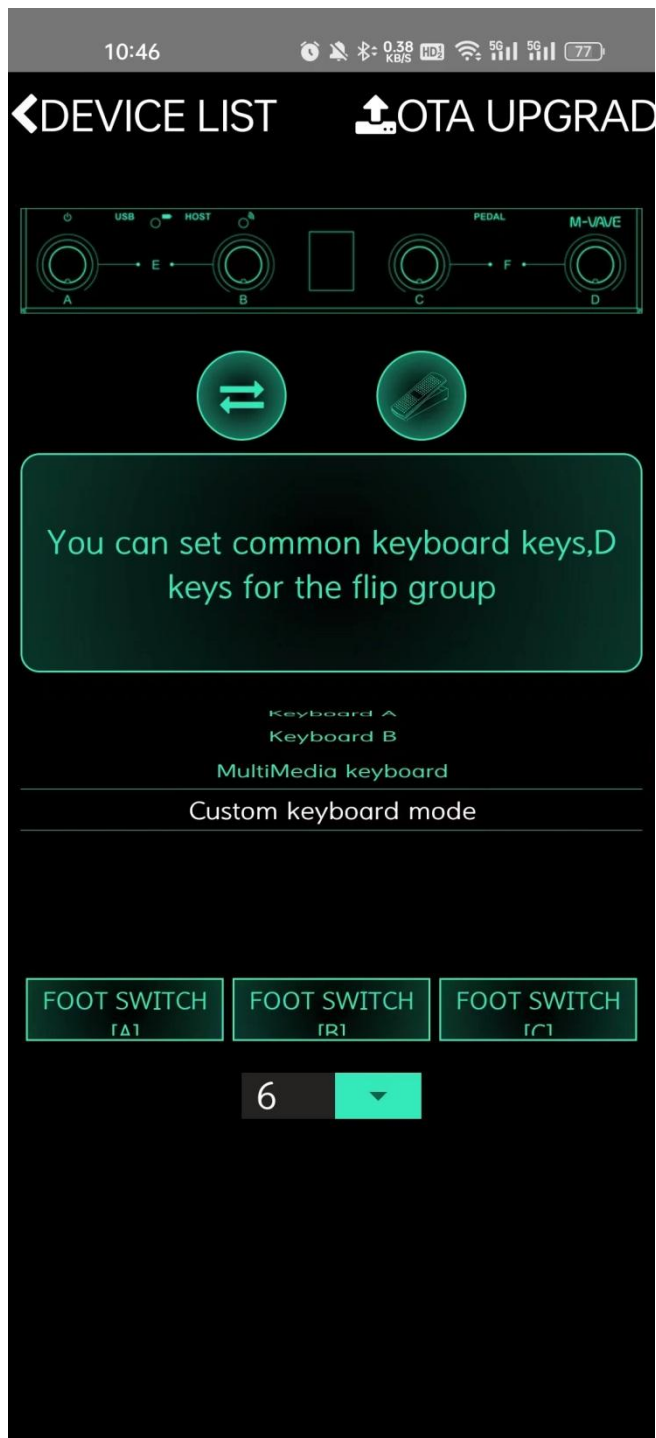

Content: Each footswitch can be set to a single key or a combination of keys. Banks can be switched using buttons E and F, with a total of 18 (groups of) keys.



#### Combination Keys:

Combination Key 1 and Combination Key 2: Include Ctrl, Shift, Alt, and Win/Command. Note that Combination Key 1 and Combination Key 2 cannot use the same settings.

Combination Key 3: Includes all other keys (letters A-Z, arrow keys, Page Up/Page Down, F1-F9).

Example: To set a combination key Ctrl+Shift+Z:

Set Ctrl in Combination Key 1

Set Shift in Combination Key 2

Set Z in Combination Key 3

This achieves the desired combination effect.